

Wrenches (Allen Keys)

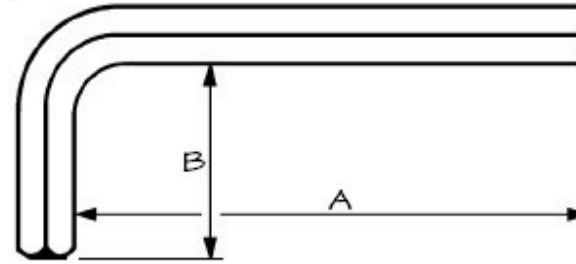

Socket Size	S		B		C			
	Hex Width A/F		Length of Short Arm		Length of Long Arm			
	Max	Min	Max	Min	Short Series		Long Series	
	Max	Min	Max	Min	Max	Min	Max	Min

0.71	0.711	0.682	8	3	34	28	69	63
0.89	0.899	0.864	11	6	34	28	71	65
1.27	1.270	1.231	16	11	44	39	75	69
1.5	1.500	1.455	14	13	45	43	78	78
2	2.000	1.955	16	15	50	48	83	81
2.5	2.500	2.455	18	17	56	53	90	87
3	3.000	2.940	20	18	63	60	100	97
4	4.000	3.940	25	23	70	66	106	102
5	5.000	4.840	28	26	80	76	118	114
6	6.000	5.192	32	30	90	86	140	136
8	8.000	7.920	36	34	100	95	160	155
10	10.000	9.920	40	38	112	106	170	164
12	12.000	11.920	45	43	125	119	212	206
14	14.000	13.900	56	53	140	133	236	229
17	17.000	16.800	63	60	160	152	250	242
19	19.000	18.900	70	67	180	171	280	271

A Hex Key, Allen Wrench or Allen Key, is a simple tool used to tighten socket screws.

The tool is usually formed of a single piece of hexagon rod of hardened steel, with blunt ends to fit snugly into the screws socket, bent in a “L” shape with unequal arms.