

# Tee Nuts

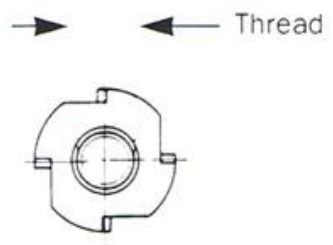
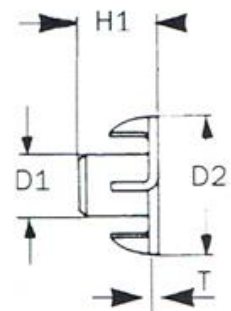

<u>Thread Size</u>	<u>D1</u>	<u>D2</u>	<u>H1</u>	<u>T</u>
--------------------	-----------	-----------	-----------	----------

M3	4.5	13	5	0.9
M4	5.2	15	6	1
M5	6.1	18	6	1.2
M5	6.5	17	8	1.2
M6	7.5	19	7	1.2
M6	7.5	19	9	1.2
M6	7.5	19.1	12	1.2
M6	7.5	19.1	15.4	1.2
M8	10	22	11	1.5
M8	9.7	22.2	14.3	1.6
M8	9.7	22.2	17.5	1.6
M10	11.5	24.5	17.4	1.5
M10	12	25	12	1.8
M12	14	27	14	1.8

T nut or tee nut is a type of nut used to fasten a wood, particle or composite materials workpiece, leaving a flush surface. It has a long, thin body and a flange at one end, resembling a T in profile.