

Hexagon Head Setscrews

DIN 933 / ISO 4017

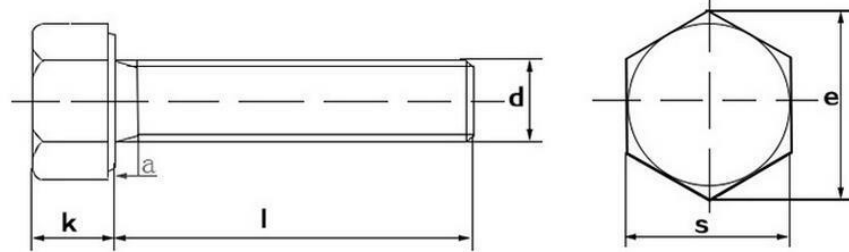
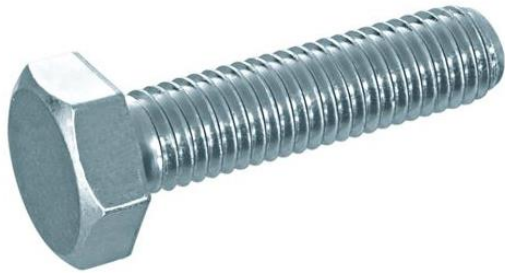

d	M3	M4	M5	M6	M8	M10	M12	M14	M16	M18	M20	M22	M24	M27	M30
k	2	2.8	3.5	4	5.3	6.4	7.5	8.8	10	11.5	12.5	14.0	15	17	18.7
e-min	6.01	7.66	8.79	11.05	14.38	18.90	21.10	24.49	26.75	30.14	33.53	35.72	39.98	45.20	50.85
s	5.5	7	8	10	13	17	19	22	24	27	30	32	36	41	46

Ideal for many applications in assembly of steel work, industrial equipment, building and automotive industries. Most commonly in 8.8 grade steel with bright zinc finish but also in self-colour & hot dip galvanised. Other high tensile steel grades are available, also offered in stainless steel, brass and nylon.

Various lengths available.