

# Threaded Rod Studding DIN 976-1/DIN 975

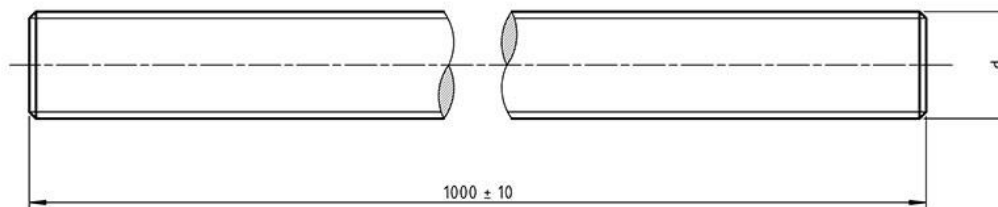

M3	M4	M5	M6	M8	M10	M12	M14	M16	M18	M20	M24	M27	M30	M33	M36	M39	M42
----	----	----	----	----	-----	-----	-----	-----	-----	-----	-----	-----	-----	-----	-----	-----	-----

For use as tie rods or for suspending ceilings, trunking, ducting etc. Long connector nuts available. Also known as all thread or threaded bar. They are Available in 1, 2 or 3 metre lengths. Material: Zinc plated steel, also high tensile steel, brass and stainless steel.

**Tel: 01234 346242**  
[www.challenge-europe.co.uk](http://www.challenge-europe.co.uk)  
[sales@challenge-europe.co.uk](mailto:sales@challenge-europe.co.uk)